

MAGIC PhonerSet

Provisioning Guide

Grandstream GXV3350
Grandstream GXV3370
Grandstream GXV3380

Version: 1.300 (10 February 2022)

© 2021, AVT Audio Video Technologies GmbH

Content

- Overview

- Features
- Grandstream GXV3350
- Grandstream GXV3370
- Grandstream GXV3380
- Why customising the phone

- Initial Setup

- IP Address
- Default Login
- Grandstream Firmware

- Customisation

- Install Customisation File
- Install AVT Wallpaper
- Install PhonerSet App
- Set Default Phone Application
- Home Screen

- Support

MAGIC PhonerSet

Overview

Features

- PhonerSet with MAGIC TH2plus

- Operation of 1 or 2 lines.
- Up to two PhonerSet phones per device.
- Compatible with firmware versions from 3.100

- PhonerSet with MAGIC TH6

- Operation of individual lines.
- Operation of all lines of a studio.
- Up to six PhonerSet phones per device.
- Compatible with firmware versions from 3.110

- PhonerSet with MAGIC THipPro

- Operation of up to 10 lines of a studio.
- Switching between studios in the App.
- Up to 8 PhonerSet phones per device.
- Compatible with firmware versions from 3.210

Grandstream GXV3350

- 5" touchscreen.
 - 1280 x 720
- Pretalk per:
 - Telephone handset.
 - Loudspeaker and microphone.
- Keypad beneath the screen.
- Status LED to display:
 - Incoming calls.
 - Active pretalk.
 - Alarms of the hybrid.



Grandstream GXV3370

- 7" touchscreen.
 - 1024 x 600
- Pretalk per:
 - Telephone handset.
 - Speaker and microphone.
- The dial pad is permanently displayed on the touchscreen.
- Status LED to display :
 - Incoming calls.
 - Active pretalk.
 - Alarms of the hybrid.



Grandstream GXV3380

- 8" touchscreen.
 - 1280 x 800
- Pretalk per:
 - Telephone handset.
 - Speaker and microphone.
- The dial pad is permanently displayed on the touchscreen.
- Status LED to display :
 - Incoming calls.
 - Active pretalk.
 - Alarms of the hybrid.



Why customising the phone?

- The telephone needs to be customised to
 - remove unused App icons.
 - install an AVT Wallpaper.
 - make the PhonerSet App the default phone application.
 - set the phone to the default configuration.
- AVT provides customisation files specific to each device.
- The files are bundled to an archive including:
 - this document
 - customisation files:
 - gxv3350cust
 - gxv3370cust
 - gxv3380cust
 - AVT Wallpaper



MAGIC PhonerSet

Initial Setup

IP Address

- First, setup the IP address via the touchscreen of the telephone.
- Swipe to the second panel of the home screen.
- Tap SETTINGS.
- Scroll down to the NETWORK category and select ETHERNET SETTINGS.
- Tap IPV4 SETTINGS on the ETHERNET SETTINGS screen.
- Set IPV4 ADDRESS TYPE: Static IP
- Enter IP parameters valid for your network.
- Tap the checkmark in the upper right corner to save the settings.

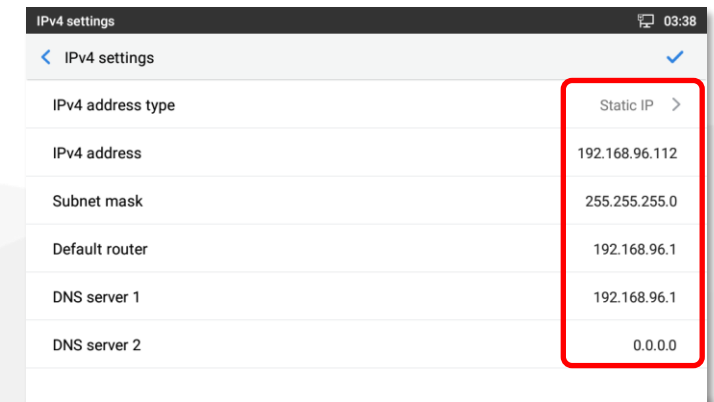
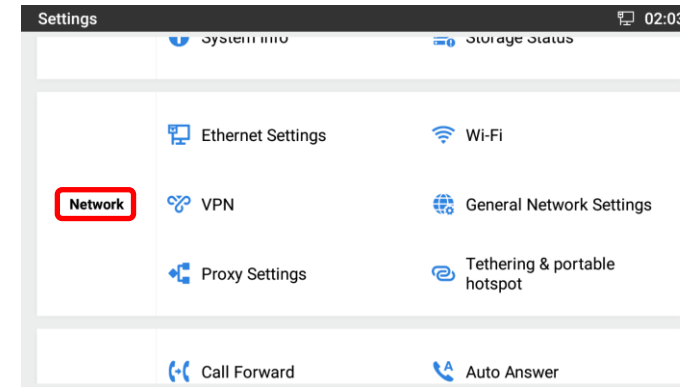

Web GUI

- Enter the IP address of the telephone in a Browser on your PC.
- The telephone will present a login screen.
- The credentials for the first login are:
 - USER: admin
 - PASSWORD GXV3350: The password is printed on the bottom of the phone next to serial number and MAC address.
 - Password GXV3370 / GXV3380: admin

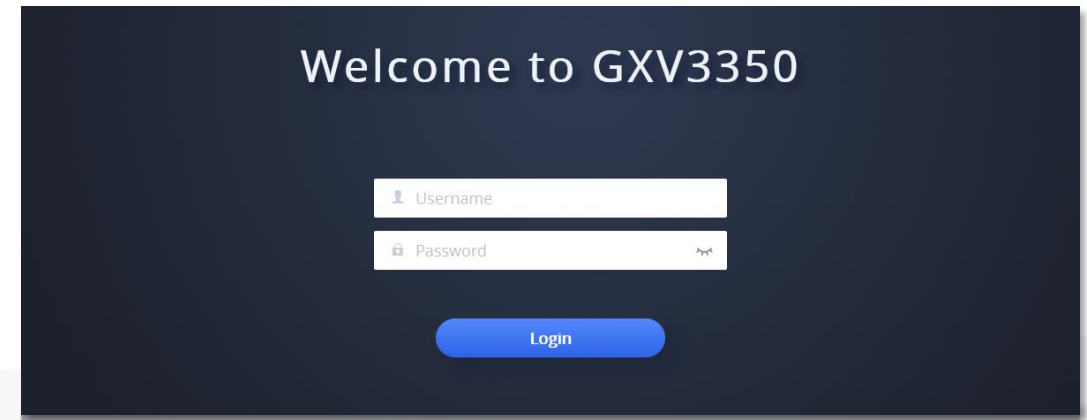
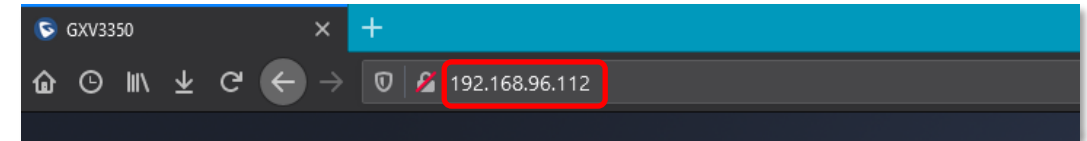

Default Login

- The Admin Password must be set to the default password which is mentioned in the PhonerSet User Manual.
- Change the password under SYSTEM SETTINGS – SECURITY SETTINGS – USER INFO MANAGEMENT
- Set the password to **!admin1**

The screenshot displays the GXV3350 web interface. On the left sidebar, the 'System Settings' menu is expanded, and 'Security Settings' is highlighted. The main content area shows the 'User Info Management' tab, which is also highlighted. Within this tab, a red box encloses the password management section. This section includes four input fields: 'Current Admin Password' (masked with dots), 'New Admin Password' (containing '!admin1'), 'Confirm New Admin Password' (containing '!admin1'), and two empty fields for 'New User Password' and 'Confirm New User Password'. Each field has a toggle icon to its right. A 'Save' button is located at the bottom right of the form. The footer of the page contains the copyright notice: 'Copyright © Grandstream Networks, Inc. 2020. All Rights Reserved. | Grandstream Software License Agreement'.

Grandstream Firmware Version

- Make sure the telephone runs at least **System Version 1.0.3.30**.
- Go to MAINTENANCE → UPGRADE → FIRMWARE on the Grandstream Web GUI.
- Check the CURRENT SYSTEM VERSION ① in the lower right corner.
- If the system version is lower than 1.0.3.30 or not displayed, download the latest firmware for the phone from the Grandstream website:
<http://www.grandstream.com/support/firmware>
- Unzip the downloaded file to your PC.
- Click UPLOAD ② and select the file: **gxv33x0fw.bin**.
- The new firmware is active after a restart.

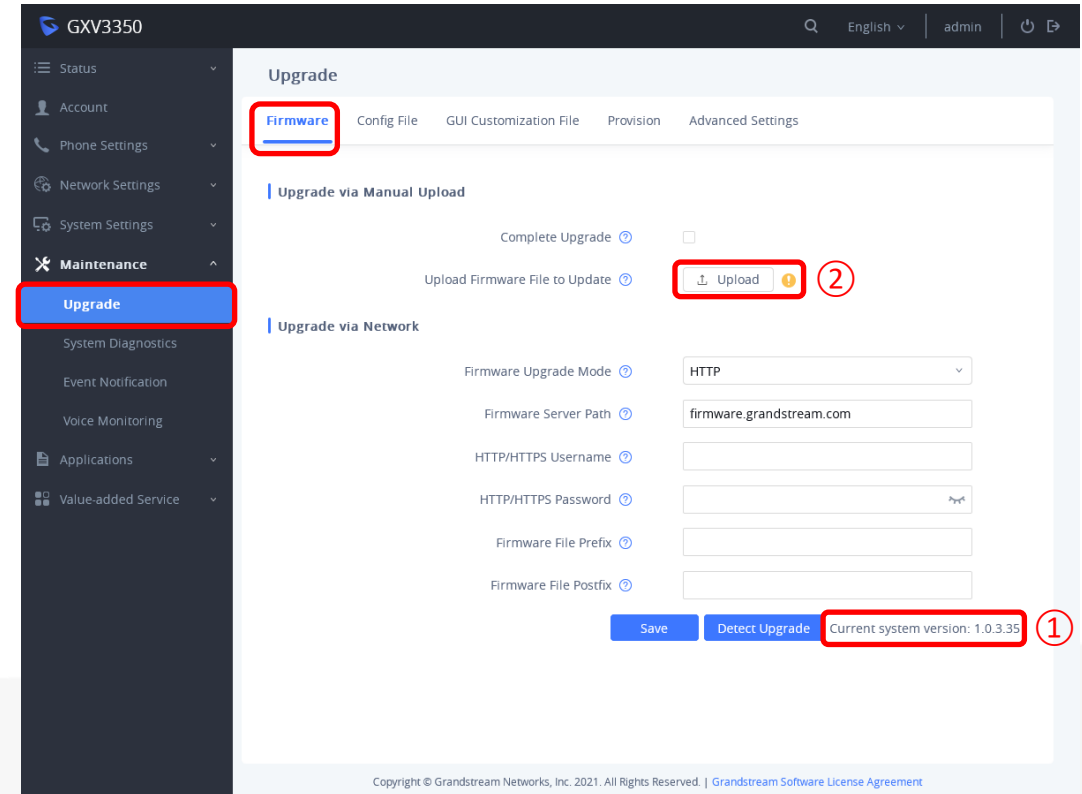

MAGIC PhonerSet

Customisation

Customisation File

- Go to MAINTENANCE → UPGRADE → GUI Customisation File on the Grandstream phone's Web GUI.
- Tap on BROWSE under UPLOAD GUI CUSTOMIZATION FILE and select the file matching the phone:
 - GXV3350: **gxv3350cust**
 - GXV3370: **gxv3370cust**
 - GXV3380: **gxv3380cust**
 - The files come with this manual.
- Allow up to 5 minutes for the phone to process the file and automatically restart.

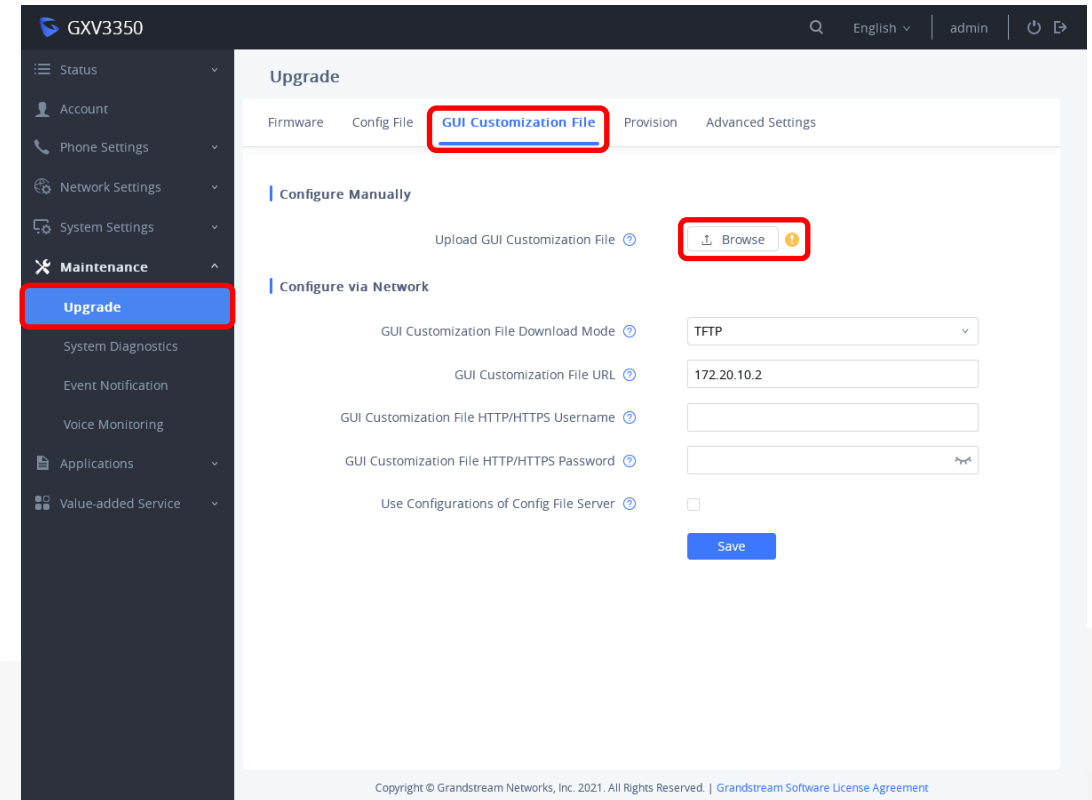

Wallpaper (1)

- After the reboot most of the app icons on the home screen should be gone.
- The AVT wallpaper should be displayed on the home screen.
- If not:
- Copy the content of the archive that came with this manual to a USB Flash Drive.
- Plug the USB Flash Drive into the telephone.
 - The USB port of the GXV3350 is located on the back of the telephone.
 - The USB port of the GXV3370 and GXV3380 is located behind a flap on the right side of the phone.

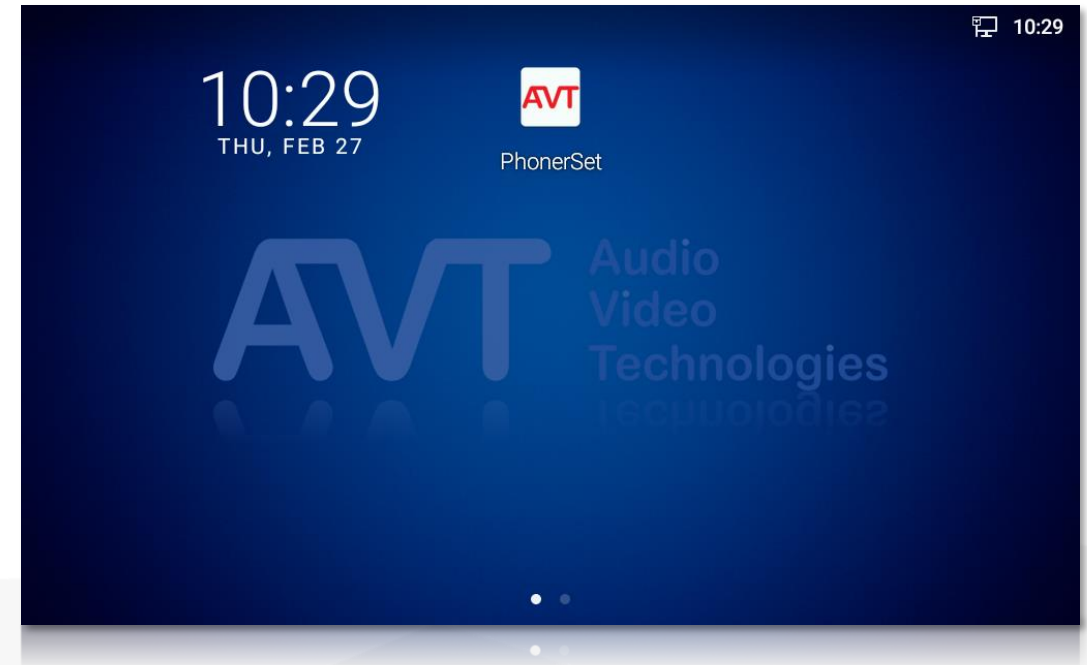

Wallpaper (2)

- Tap FILE MANAGER on the home screen of the telephone and go to USB DRIVE – WALLPAPER.
- Press and hold the **AVT PhonerSet Wallpaper.png** file.
- Select COPY
- Go to INTERNAL STORAGE – WALLPAPER
- Paste the file using the icon in the upper right corner of the screen.
- Tap and hold the file **AVT PhonerSet Wallpaper.png**.
- Select SET WALLPAPER.

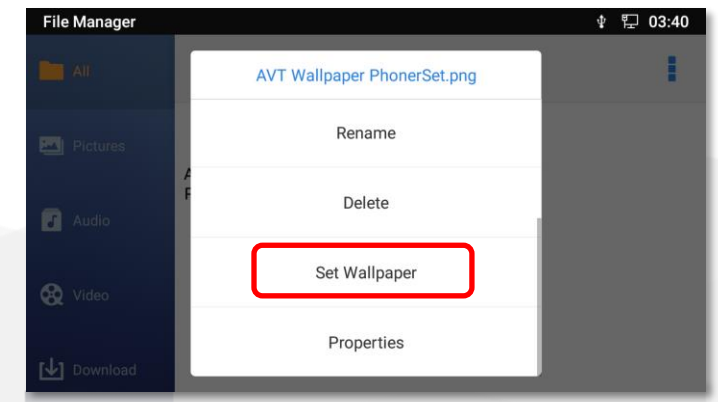
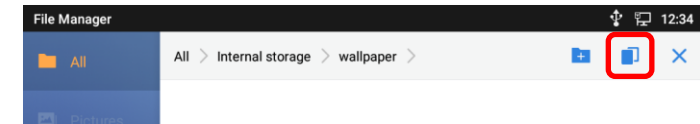
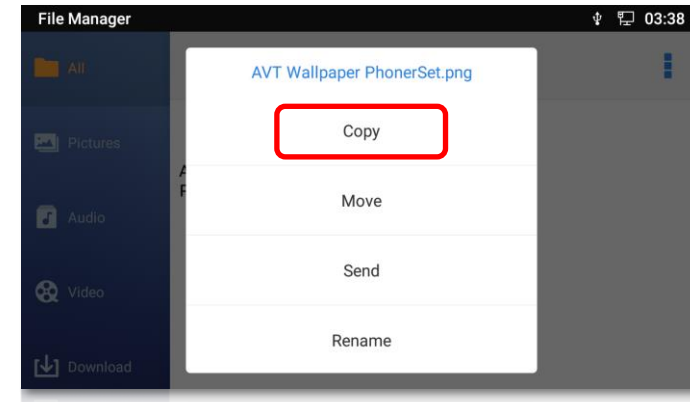

Install PhonerSet App (1)

- Download the latest version of the MAGIC PhonerSet App from the download section of the AVT website:
<https://avt-nbg.de/en/downloads/software>
- Copy the MAGIC PhonerSet App to a USB Flash Drive.
- Insert the USB Flash Drive into the USB port of the phone.
 - GXV3350: The USB port is located at the back of the telephone.
 - GXV3370 / GXV3380: The USB port is located behind the flap on the right side of the telephone.

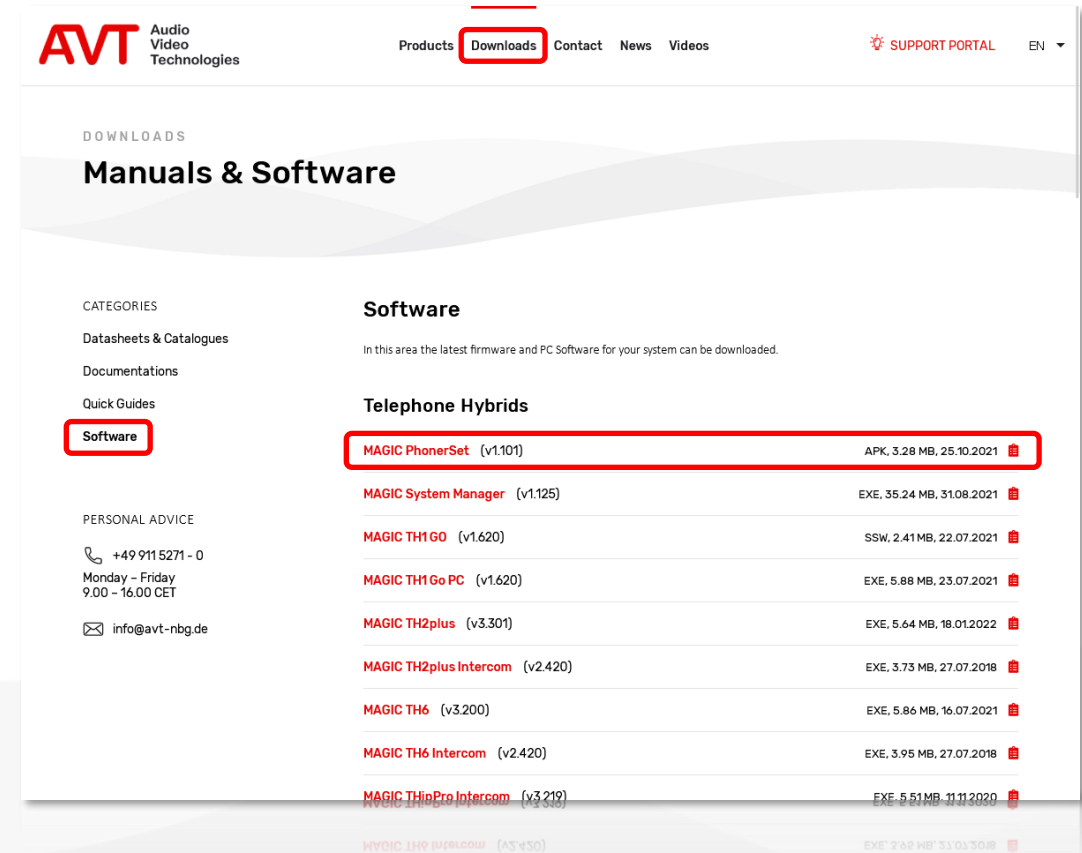

Install PhonerSet App (2)

- Allow the installation of an app from a USB Flash Drive in the settings.
- To do this, open SETTINGS on the home screen of the telephone, scroll down to the BASIC category and tap SECURITY SETTINGS.
- Enable UNKNOWN SOURCES and confirm the subsequent safety warning with OK.

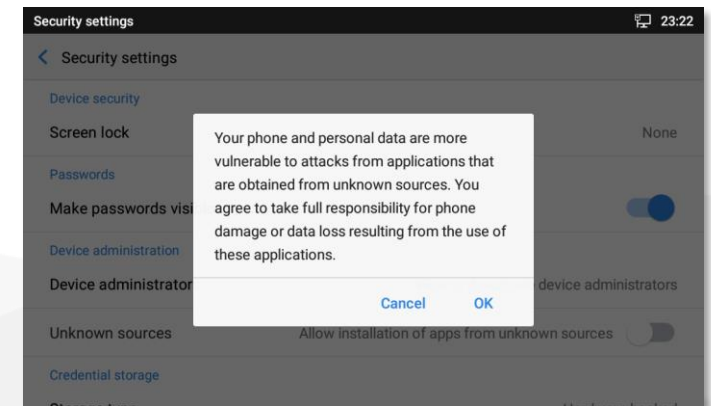
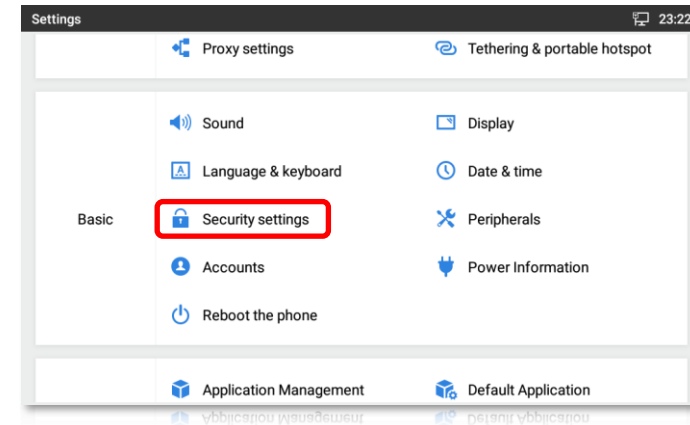

Install PhonerSet App (3)

- Open the FILE MANAGER from the home screen of the telephone.
- Navigate to the MAGIC PhonerSet App on the USB DRIVE and tap it.
- In the confirmation request dialog box, tap INSTALL and wait for the update process to complete.

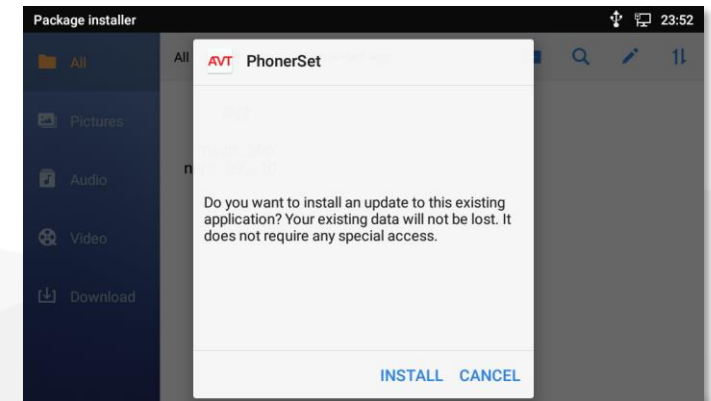
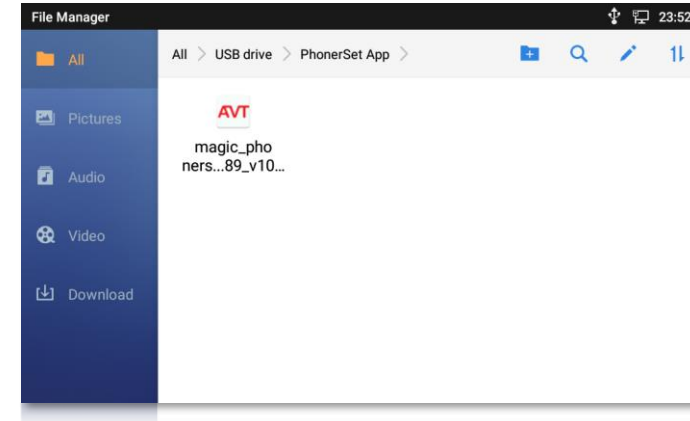

Default Phone Application

- Set the MAGIC PhonerSet App as default phone application.
- Open SETTINGS from the home screen of the telephone.
- Scroll down to the APPS category and select DEFAULT APPLICATION.
- Tap PHONE APP and select AVT PHONERSET.

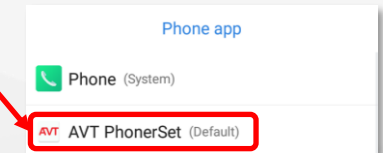
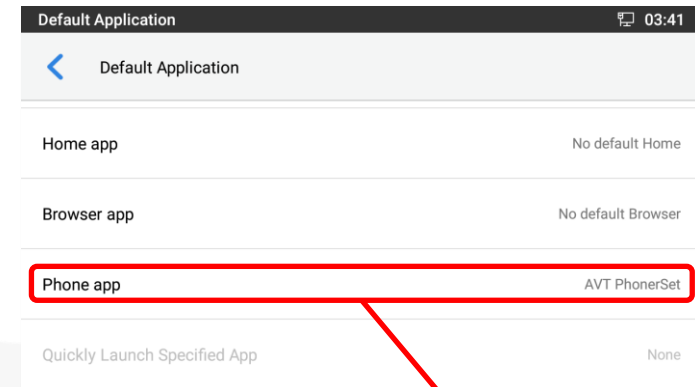
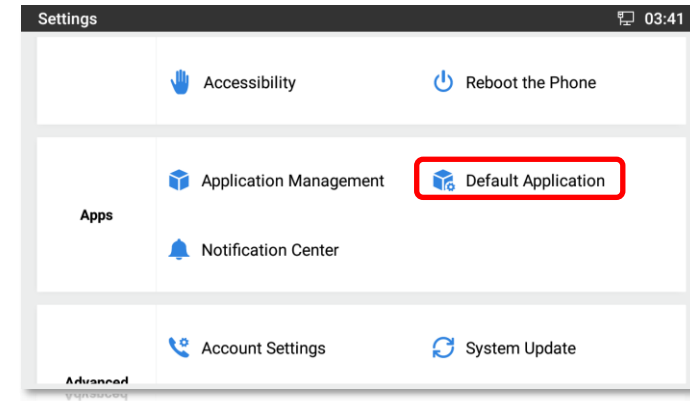

Home Screen

- Place date and time as well as the MAGIC PhonerSet icon on the first page of the home screen.
- Place all other icons on the second page of the home screen.
- Rearrange the Icons if necessary.
- Check if the AVT wallpaper is displayed.
- Find more information on configuring and operation the PhonerSet app in the Magic PhonerSet manual available on our website.





Support Hotline
+49 911 2571 110



Support-Portal
avt-nbg.zammad.com



Support E-Mail
support@avt-nbg.de

Support

A modern, multi-story office building with a glass facade and a prominent overhang. The building is partially covered by a large, semi-transparent red geometric overlay on the right side. The sky is blue with scattered white clouds. A tree is visible in the foreground between the two building sections.

AVT

Audio
Video
Technologies

AVT Audio Video Technologies
90411 Nürnberg
Nordostpark 91
Germany